





Interactive Platform Advanced key technology

Interactive platform builds on the foundation and innovation of the Interactive system

Interactive increases security effectiveness with a telescopic pin tumbler mechanism that requires the simultaneous alignment of both internal and external shear lines for plug rotation.

Featuring enhanced intrusion protection, Interactive is highly pick, drill and bump resistant.

Coded key cards and service through trained and authorized dealers help prevent unauthorized duplication

Available in all formats and product types — retrofit cylinders, padlocks, locks and multi-point locks — one key can fit them all.

Master keying capabilities allow users to design the system they need

Interactive Platform meets the world's most stringent standards.



Classic Platform

Classic platform is based on several special features:

Unique telescopic pin tumbler mechanism, with internal and external pins – requiring the simultaneous alignment of both internal and external shear lines for the plug to rotate.

A specially designed plug, which forms a spherical, 3-dimensional shear line with the top and bottom pins, within the cylinder body.

Steel inserts with high drill resistance High pick and bumping resistance

Optional side and back pins, specially suited for master key systems.

A coded key card supplied in every package, to enhance key security. Additional keys may be cut by authorized dealers, upon presentation of the key card – in accordance with Our official key cutting procedures.

The Classic platform meets the requirements of some of the most stringent European and American standards.

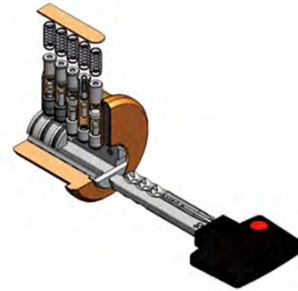

7X7 Platform

7X7 is Our standard platform, providing an excellent level of basic security and exceptional value for money.

The 7x7 features: A pin tumbler mechanism with 7 chambers A reversible nickel silver key with a plastic head

The 7x7 platform may be keyed alike, keyed different or master keyed.

Key limitation is ensured by the key and key blank, supplied together with a coded key card. Additional keys may be cut by authorized dealers, upon presentation of the key card – in accordance with our official key cutting procedures.

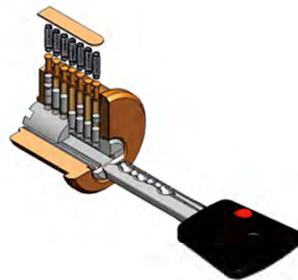

Mortise Cylinder

Application

Compatible with residential and commercial door locksets. Interfaces with locksets of major brands (see available cams). Can retrofit a 'Jumbo' cylinder with an adaptor ring.

Operation

360° rotation by operating key or thumbturn.

Materials

Body and plug: high quality brass Cam: steel Pins: nickel silver and stainless steel

Standard finish

Nickel chrome matt, nickel chrome, shiny brass

Special finishes

Antique bronze, black, antique brass, PVD

Cylinder mechanism

Unique, high precision pin tumbler system.

Keys

Reversible nickel silver key with plastic key head and colored insert. Also available in all nickel silver.

Cylinder options

- Classic, Interactive platforms
- Keyed different, keyed alike
- Master keyed
- Variety of Cams

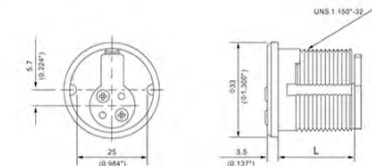

Adams Rite type PIN 8500020	Yale standard type PIN 8500014	Rubens type PIN 8500019	Flange type PIN 8500041	Lockwood type PIN 8500054
Single type PIN 8500028	Schlage type PIN 8500037	Target offset type PIN 8500032	Jumbo type PIN 8500012 (flange type 8500015)	Balisen type PIN 8500011
Yale type PIN 8500185	Yale type PIN 1517508	Yale type A&S PIN 8500035	Yale type 210 PIN 8500018	

Length available(mm)

Cylinder	L	
	mm	Inch
1" (+)	23.1	0.909
1 1/4"	27.1	1.067
1 1/2"	30.3	1.193
1 3/4"	33.5	1.318
1 7/8"	36.7	1.445
1 3/4"	43.1	1.697
2"	49.5	1.949

*Product with 4 chambers, not UL Listed.

Spacer ring

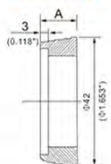

A	
mm	Inch
5.7	0.224
8.9	0.350
12.2	0.480
15.5	0.610

*Supplied as standard



Key In Knob (K.I.K.) Cylinder

Application

These cylinders are used in cylindrical locksets, deadbolts. We provides an extensive range to fit a wide variety of popular brands.

Operation

Rotation by operating key.

Materials

Body and plug: high quality brass Tail pieces: steel Pins: nickel silver and stainless steel

Standard finish

Nickel chrome matt, shiny brass

Special finishes

Nickel chrome, antique Bronze, antique brass

Cylinder mechanism

Unique, high precision pin tumbler system.

Keys

Reversible nickel silver key with plastic key head and colored insert. Also available in all nickel silver.

Cylinder options

Classic, Interactive platforms
Keyed different, keyed alike
Master keyed

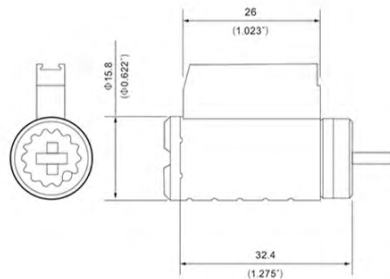

Single Open Cylinder-Normal Key

Material:

Cylinder body:high quality brass
Key:steel/brass/cupronickel
Cam:heat-treatment steel
Spring stainless steel/phosphorous bronze
Pin:brass with high combination

Features:

- 1.Single row pins patented
- 2.A,B,C construction key
- 3.Mastering
- 4.Optional anti-drill feature
- 5.Suitable for residential commercial,public areas

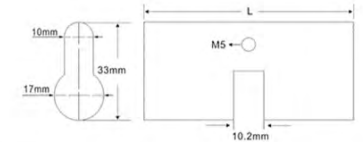

Material	High Quality Solid Brass
Color	SN/AB/PB/SB/CP/NB
Dimension	60/65/70/75/80/85/90/95/100/120/140mm

Double Open Cylinder-Computer Key

Material:

Cylinder body:high quality brass
Key:steel/brass/cupronickel
Cam:heat-treatment steel
Spring stainless steel/phosphorous bronze
Pin:brass with high combination

Features:

- 1.Single row pins patented
- 2.A,B,C construction key
- 3.Mastering
- 4.Optional anti-drill feature
- 5.Suitable for residential commercial,public areas

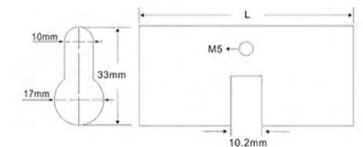

Material	High Quality Solid Brass
Color	SN/AB/PB/SB/CP/NB
Dimension	60/65/70/75/80/85/90/95/100/120/140mm



TOPS-01
Half Open Cylinder-Normal Key

Material:
Cylinder body:high quality brass
Key:steel/brass/cupronickel
Cam:heat-treatment steel
Spring:stainless steel/phosphorous bronze
Pin:brass with high combination

- Features:**
- 1.Single row pins patented
 - 2.A.B.C.construction key
 - 3.Mastering
 - 4.Optional anti-drill feature
 - 5.Suitable for residential commercial,public areas

Material	High Quality Solid Brass
Color	SN/AB/PB/SB/CP/NB
Dimension	60/65/70/75/80/85/90/95/100mm

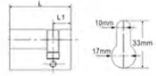

TOPS-02
Double Open Cylinder-Normal Key

Material:
Cylinder body:high quality brass
Key:steel/brass/cupronickel
Cam:heat-treatment steel
Spring:stainless steel/phosphorous bronze
Pin:brass with high combination

- Features:**
- 1.Single row pins patented
 - 2.A.B.C.construction key
 - 3.Mastering
 - 4.Optional anti-drill feature
 - 5.Suitable for residential commercial,public areas

Material	High Quality Solid Brass
Color	SN/AB/PB/SB/CP/NB
Dimension	60/65/70/75/80/85/90/95/100mm



TOPS-05
Single Open Cylinder-Normal Key

Material:
Cylinder body:high quality brass
Key:steel/brass/cupronickel
Cam:heat-treatment steel
Spring:stainless steel/phosphorous bronze
Pin:brass with high combination

- Features:**
- 1.Single row pins patented
 - 2.A.B.C.construction key
 - 3.Mastering
 - 4.Optional anti-drill feature
 - 5.Suitable for residential commercial,public areas

Material	High Quality Solid Brass
Color	SN/AB/PB/SB/CP/NB
Dimension	60/65/70/75/80/85/90/95/100mm

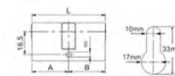

TOPS-06
Single Open Cylinder-Normal Key

Material:
Cylinder body:high quality brass
Key:steel/brass/cupronickel
Cam:heat-treatment steel
Spring:stainless steel/phosphorous bronze
Pin:brass with high combination

- Features:**
- 1.Single row pins patented
 - 2.A.B.C.construction key
 - 3.Mastering
 - 4.Optional anti-drill feature
 - 5.Suitable for residential commercial,public areas

Material	High Quality Solid Brass
Color	SN/AB/PB/SB/CP/NB
Dimension	60/65/70/75/80/85/90/95/100mm

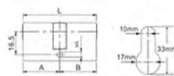

TOPS-03
Single Open Cylinder-Normal Key

Material:
Cylinder body:high quality brass
Key:steel/brass/cupronickel
Cam:heat-treatment steel
Spring:stainless steel/phosphorous bronze
Pin:brass with high combination

- Features:**
- 1.Single row pins patented
 - 2.A.B.C.construction key
 - 3.Mastering
 - 4.Optional anti-drill feature
 - 5.Suitable for residential commercial,public areas

Material	High Quality Solid Brass
Color	SN/AB/PB/SB/CP/NB
Dimension	60/65/70/75/80/85/90/95/100mm

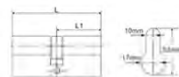

TOPS-04
Double Open Cylinder-Computer Key

Material:
Cylinder body:high quality brass
Key:steel/brass/cupronickel
Cam:heat-treatment steel
Spring:stainless steel/phosphorous bronze
Pin:brass with high combination

- Features:**
- 1.Single row pins patented
 - 2.A.B.C.construction key
 - 3.Mastering
 - 4.Optional anti-drill feature
 - 5.Suitable for residential commercial,public areas

Material	High Quality Solid Brass
Color	SN/AB/PB/SB/CP/NB
Dimension	60/65/70/75/80/85/90/95/100mm

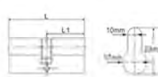

TOPS-07
Bathroom Or Passage Cylinder

Material:
Cylinder body:high quality brass
Key:steel/brass/cupronickel
Cam:heat-treatment steel
Spring:stainless steel/phosphorous bronze
Pin:brass with high combination

- Features:**
- 1.Single row pins patented
 - 2.A.B.C.construction key
 - 3.Mastering
 - 4.Optional anti-drill feature
 - 5.Suitable for residential commercial,public areas

Material	High Quality Solid Brass
Color	SN/AB/PB/SB/CP/NB
Dimension	60/65/70/75/80/85/90/95/100mm



TOPS-08
Bathroom Or Passage Cylinder

Material:
Cylinder body:high quality brass
Key:steel/brass/cupronickel
Cam:heat-treatment steel
Spring:stainless steel/phosphorous bronze
Pin:brass with high combination

- Features:**
- 1.Single row pins patented
 - 2.A.B.C.construction key
 - 3.Mastering
 - 4.Optional anti-drill feature
 - 5.Suitable for residential commercial,public areas

Material	High Quality Solid Brass
Color	SN/AB/PB/SB/CP/NB
Dimension	60/65/70/75/80/85/90/95/100mm





TOPS-09
Double Open Oval Cylinder-Normal Key

Material:
Cylinder body:high quality brass
Key:steel/brass/cupronickel
Cam:heat-treatment steel
Spring:stainless steel/phosphorous bronze
Pin:brass with high combination

Material	High Quality Solid Brass
Color	SN/AB/PB/SB/CP/NB
Dimension	45/50/55/60/65/70/75/80/85/90/95/100mm

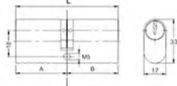

- Features:**
- 1.Single row pins patented
 - 2.A.B.C.construction key
 - 3.Mastering
 - 4.Optional anti-drill feature
 - 5.Suitable for residential commercial,public areas

TOPS-10
Double Open Oval Cylinder-Normal Key

Material:
Cylinder body:high quality brass
Key:steel/brass/cupronickel
Cam:heat-treatment steel
Spring:stainless steel/phosphorous bronze
Pin:brass with high combination

Material	High Quality Solid Brass
Color	SN/AB/PB/SB/CP/NB
Dimension	60/65/70/75/80/85/90/95/100mm

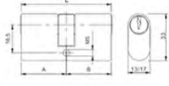

- Features:**
- 1.Single row pins patented
 - 2.A.B.C.construction key
 - 3.Mastering
 - 4.Optional anti-drill feature
 - 5.Suitable for residential commercial,public areas



TOPS-11
Double Open Oval Cylinder-Computer Key

Material:
Cylinder body:high quality brass
Key:steel/brass/cupronickel
Cam:heat-treatment steel
Spring:stainless steel/phosphorous bronze
Pin:brass with high combination

Material	High Quality Solid Brass
Color	SN/AB/PB/SB/CP/NB
Dimension	60/65/70/75/80/85/90/95/100mm

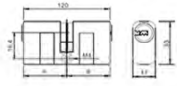

- Features:**
- 1.Single row pins patented
 - 2.A.B.C.construction key
 - 3.Mastering
 - 4.Optional anti-drill feature
 - 5.Suitable for residential commercial,public areas

TOPS-12
Double Open Oval Cylinder-Normal Key

Material:
Cylinder body:high quality brass
Key:steel/brass/cupronickel
Cam:heat-treatment steel
Spring:stainless steel/phosphorous bronze
Pin:brass with high combination

Material	High Quality Solid Brass
Color	SN/AB/PB/SB/CP/NB
Dimension	60/65/70/75/80/85/90/95/100mm

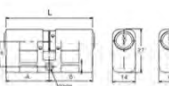

- Features:**
- 1.Single row pins patented
 - 2.A.B.C.construction key
 - 3.Mastering
 - 4.Optional anti-drill feature
 - 5.Suitable for residential commercial,public areas

Grand Master Key System

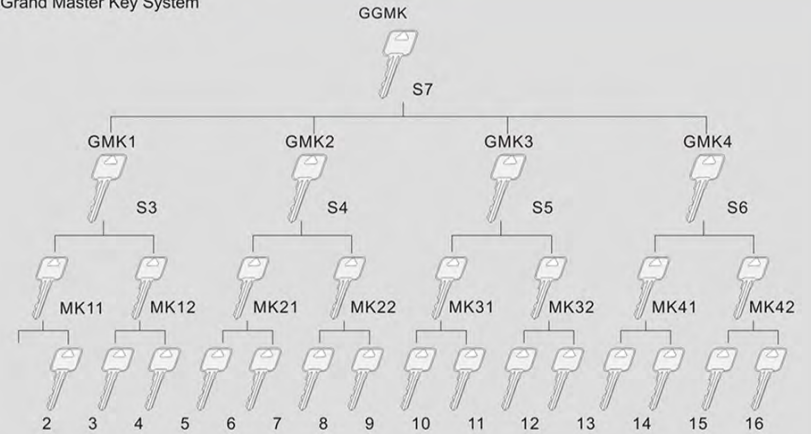

Using different key profile to do different group and different level of master keying
S3,S4,S5,S6,S7 are with different key profile

